

# **TII-Ease**

---

## **48" & 72" CULTIPACKER**



*Standard Pull Type  
Base Unit*



*With Wheel Kit*



*With 3-Point Kit*

---

# **OWNER'S MANUAL**

**With Assembly Instructions**

**For Model: TP2148 & TP3272**

---

**KUNZ ENGINEERING, INC. / MENDOTA, IL 61342 / PH (815) 539-6954**



# **SAFETY INTRODUCTION**

Your safety, and the safety of others, is very important. To help you make informed decisions about safety, we have provided operating procedures and other information in this manual. This information alerts you to potential hazards that could hurt you or others.

You will find important safety information in the following form:

**Safety Messages** – preceded by a safety alert symbol  and one of three signal words: **DANGER**, **WARNING**, or **CAUTION**.

These signal words mean:



**DANGER:** Indicates an imminently hazardous situation that, if not avoided, will result in death or serious injury. This signal word is to be limited to the most extreme situations typically for machine components which, for functional purposes, cannot be guarded.



**WARNING:** Indicates a potentially hazardous situation that, if not avoided, could result in death or serious injury, and includes hazards that are exposed when guards are removed. It may also be used to alert against unsafe practices.



**CAUTION:** Indicates a potentially hazardous situation that, if not avoided, may result in minor or moderate injury. It may also be used to alert against unsafe practices.

**This entire manual is filled with important safety information. Please read it carefully.**

## **IMPORTANT SAFETY INFORMATION**



**CAUTION:** Do not allow anyone to operate this equipment who has not fully read and comprehended the safety manual and who has not been properly trained in the safe operation of the equipment.



**CAUTION:** Operator should be familiar with all functions of the unit.



**WARNING:** Keep bystander clear while operating equipment.



**WARNING:** Do not allow riders.



**CAUTION:** Safely support and secure implement before making repairs.



**CAUTION:** Do not stand or climb on equipment.

**This entire manual is filled with important safety information. Please read it carefully.**

# ASSEMBLY INSTRUCTIONS

Read the complete assembly instructions before starting the assembly.

**You should have:**

- one cultipacker assembly
- one wheel kit (optional)
- one 3-point kit (optional)

The standard pull type Model TP2148 and TP3272 Cultipackers are fully assembled and ready for use after uncrating. If the optional wheel kit was purchased with the cultipacker please see Section A for assembly instructions. If the optional 3-point kit was purchased with the cultipacker please see Section B for assembly instructions.



**CAUTION:** Removing the cultipacker from the crate should be performed with caution. Care should be taken to prevent back injuries or other lifting related injuries.

**A. ASSEMBLY OF OPTIONAL WHEEL KIT (See Figure 1)**

1. Remove the 5/8" nut and lock washer from each wheel assembly. All other hardware should stay on the wheel assembly in the order that is shown in Figure 1.
2. Insert the end of the wheel assembly bolt through the cultipacker frame and install and securely fasten the 5/8" nut and lock washer that was removed in Step 1.

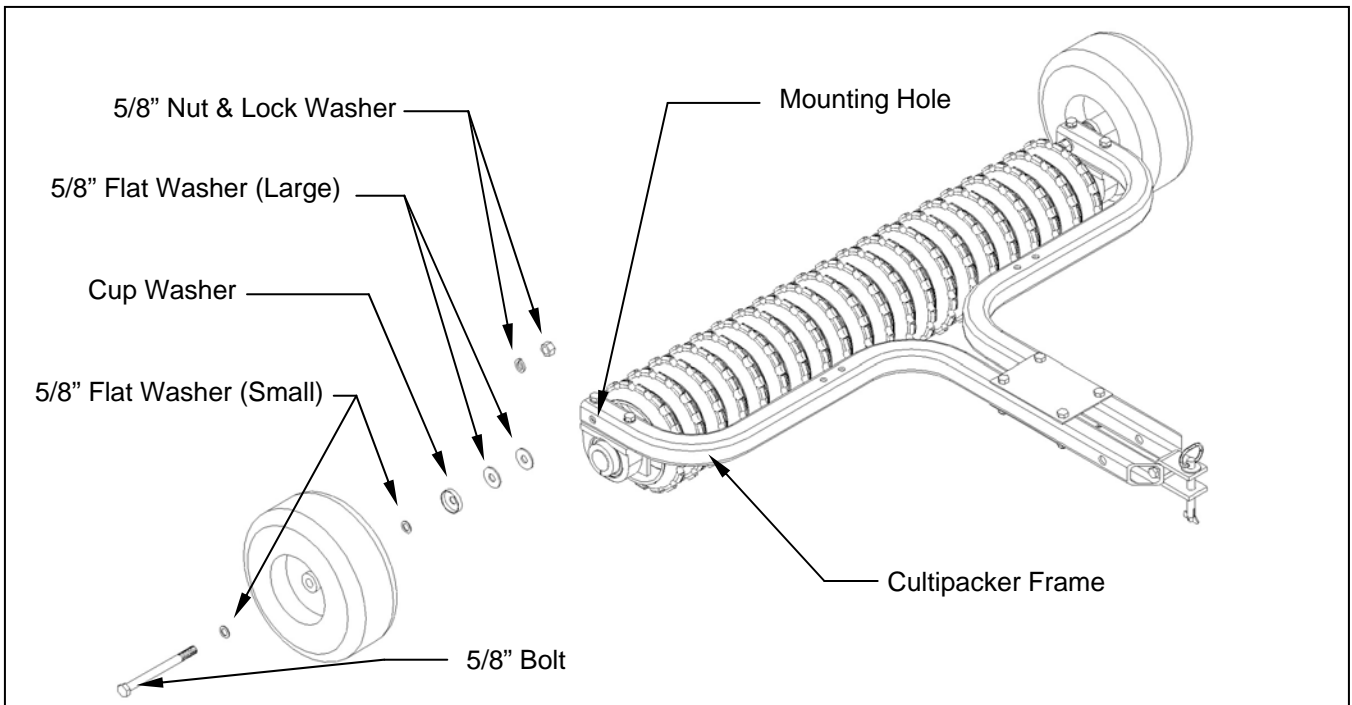

Figure 1. – Wheel Kit Assembly

**B. ASSEMBLY OF OPTIONAL 3-POINT KIT (See Figure 2)**

1. Remove the two 1/2" nuts, lock washers and bolts from each lower 3-point pin bracket.
2. Install each lower 3-point pin bracket on the cultipacker frame as shown in Figure 2. Fasten securely with the 1/2" nuts, lock washers and bolts that were removed in Step 1.
3. Install the upper top link pin.

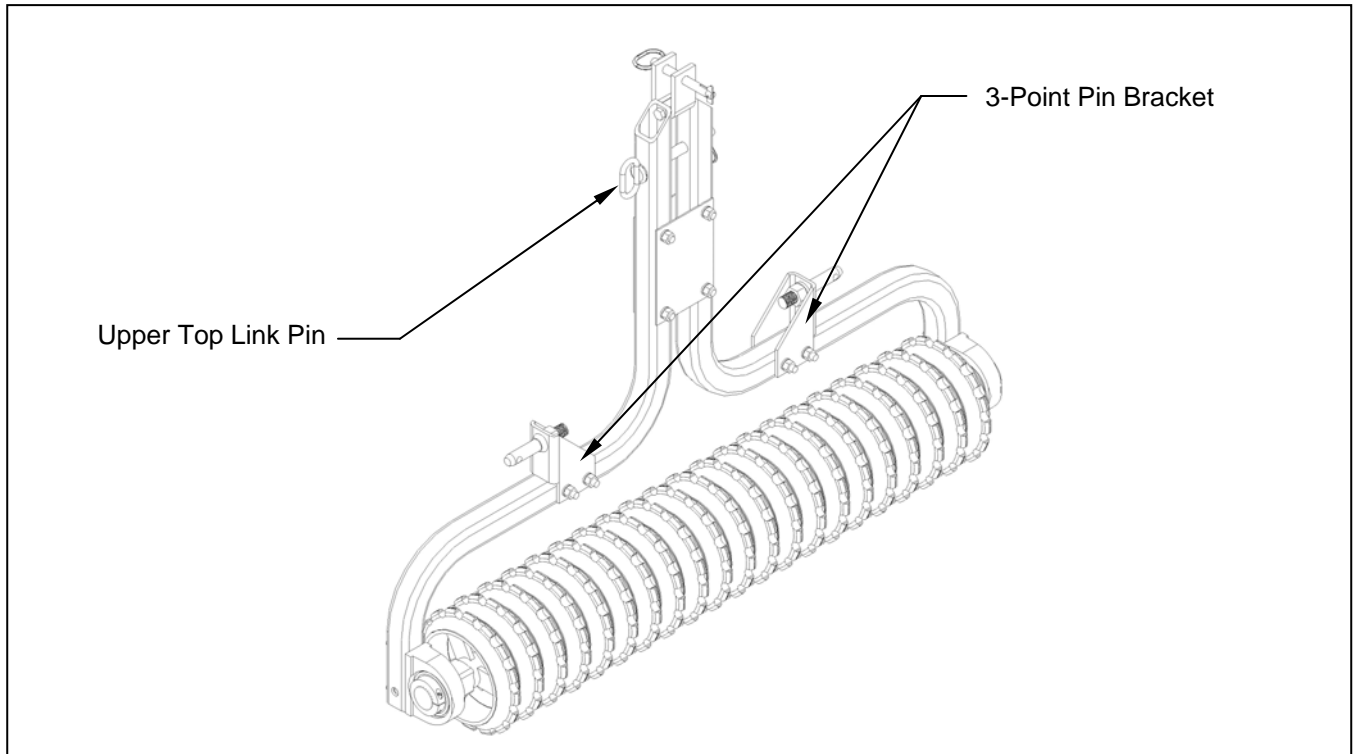

Figure 2. – Assembly of 3-Point Kit

## OPERATIONS AND MAINTENANCE



This safety alert symbol is used to indicate safety instructions. Follow these instructions to avoid personal injury and/or property damage. Read and follow all instructions in this manual.



**CAUTION:** Do not allow anyone to operate this equipment who has not fully read and comprehended the safety manual and who has not been properly trained in the safe operation of the equipment.



**CAUTION:** Operator should be familiar with all functions of the unit.



**WARNING:** Keep bystander clear while operating equipment.



**WARNING:** Do not allow riders.



**CAUTION:** Safely support and secure implement before making repairs.



**CAUTION:** Do not stand or climb on equipment.

### A. USING THE TOOL

The Model TP2148 & TP3272 have been designed to be a standard pull type cultipacker with the ability to have optional kits installed for use on multiple vehicles.

**Note:** Transporting this cultipacker on hard road type surfaces can result in excessive packer wheel wear or possible packer wheel damage.

With the optional wheel kit installed this cultipacker has been designed to be flipped over on tires for ease in transport.



**CAUTION:** Care should be taken when flipping the cultipacker over for either use or transport. Place one foot on the packer wheels and securely hold when flipping. Improper flipping can result in bodily injury and/or property damage.

With the optional 3-point kit installed this cultipacker has been designed to work on Category 1 3-point hitch systems.



**CAUTION:** Care should be taken when either mounting or removing the cultipacker from a 3-point system. Securely support the cultipacker to prevent bodily injury and or property damage.

**Note:** If both the wheel kit and 3-point kit were purchased, it will be necessary to remove the wheel kit before operating the cultipacker on a 3-point hitch mount.

For best results it may be necessary to pack the soil before seeding and then pack the soil a second time after seeding. This is especially true with small seeds that require shallow seeding.

**B. MAINTENANCE**

There are two grease points on the cultipacker. There is a bearing on each end of the packer wheel shaft. It is recommended that these bearings be greased at least every 4 hours. In dusty conditions more frequent greasing may be necessary.

## MODEL TP2148 & TP3272 PARTS LIST

<u>Item</u>	<u>Part #</u>	<u>Description</u>	<u>Quantity</u>
1	214021	Cup Washer - (Wheel Kit Only)	2
2	216012	Tension Lock Pin (5/8" Dia. x 3-1/2" Long)	1
3	216015	Lift Arm Pin (7/8" Dia. X 5-1/2" Long) - (3-Point Kit Only)	2
4	216016	Fixed Handle Hitch Pin (3/4" Dia. X 7-1/4" Long) - (3-Point Kit Only)	1
5	222013	Single Split Collar (1.75" I.D. x .69" Thick)	2
6	226001	Offset Wheel Assy., Pneumatic Turf Tread 2 Ply (13/500 x 6) - (Wheel Kit Only)	2
	243007	Wheel Bearing-Precision Sealed (1-3/8" O.D. x 5/8" I.D.)	2
	600283	Wheel Bearing Spacer	1
7	243012	Tapped Pillow Block Bearing (45mm Bore)	2
8	259007	Packer Wheel (1-3/4" Shaft, 9-1/2" Dia.) - Model TP2148	21
8	259007	Packer Wheel (1-3/4" Shaft, 9-1/2" Dia.) - Model TP3272	32
9	275018	Till-Ease Name Decal	2
9	275019	Kunz Decal	2
10	500053	3-Point Bracket - (3-Point Kit Only)	2
11	500054	Connector Plate	2
12	500055	Cultipacker Frame - Model TP3272	2
12	500058	Cultipacker Frame - Model TP2148	2
13	500056	Shaft - Model TP3272	1
13	500059	Shaft - Model TP2148	1
14	500057	Spacer	2
15	800018	Tongue Clevis	1



# **MODEL TP2148 & TP3272 PARTS**

